

# PL923



## APPLICATION

This product can be installed indoors or outdoors on concrete or a compacted aggregate base. The dual-color sand-filled putting surface features a texturized polypropylene yarn system designed to hold shots from 70-100 yards with natural ball roll with less maintenance than conventional sand-filled systems.

PROPERTY	DESCRIPTION
Primary Yarn Polymer	Polypropylene
Yarn Cross Section	Texturized Polypropylene
Standard Colors	Forest/Olive
Coating Type(s)	SilverBack™ Polyurethane
Perforations	Yes
Pile Height	1 1/8"
Total Fabric Weight	57 oz/yd <sup>2</sup>
Fabric Width	15 ft.

Yarn Type



Texturized



\*Custom colors available upon request

200 Howell Dr. Dalton GA 30721

[www.cpturf.com](http://www.cpturf.com)

800.564.4492



CONTROLLED  
PRODUCTS



# PL923

FINISHED FABRIC	ENGLISH SYSTEM		METRIC SYSTEM		ASTM TEST F-1551
Nominal Specification	Value	Units	Value	Units	Method
Pile Height (Nominal)	1	In.	25.4	mm.	D-5823
Face Weight	30	oz/yd <sup>2</sup>	1017	g/m <sup>2</sup>	D-5848
Total Fabric Weight	57	oz/yd <sup>2</sup>	1933	g/m <sup>2</sup>	D-5848
Primary backing Weight	7.4	oz/yd <sup>2</sup>	251	g/m <sup>2</sup>	D-5848
Secondary Coating Weight	20	oz/yd <sup>2</sup>	678	g/m <sup>2</sup>	D-5848
Tuft Bind	>8	lbs.	>3.6	Kg.	D-1335
Grab Tear Strength (Average)	>200	lbs.	>91	Kg.	D-5034
Lead Content	<50	ppm	<50	ppm	F-2765
Total Yarn Linear Density	4,600	Denier	5,112	D-Tex	D-1577
Tensile Strength	8.0	lbs.	3.63	Kg.	D-5034
Stitch Rate	19	Per 3"	36.33	Per 10 cm	D-5793
Machine Gauge	0.375	In.	.95	Cm.	D-5793
Flammability	TEST	PASSED	TEST	PASSED	D-2859
Water Permeability w/infill	>30	In./Hr.	>76	Cm./Hr.	F-1551
Fiber Thickness	22	mils	235	microns	D-3218
Fabric Width	15	Ft.	4.6	M	None

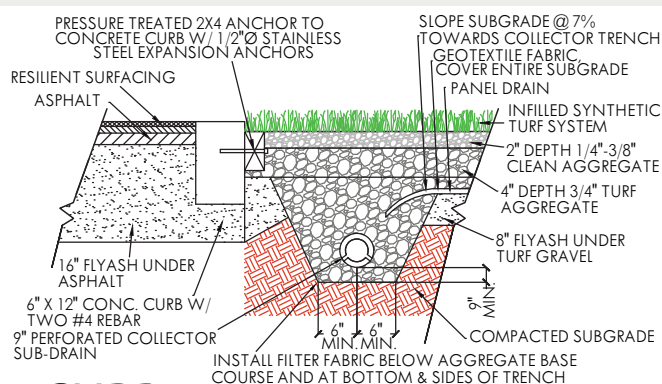

CURB

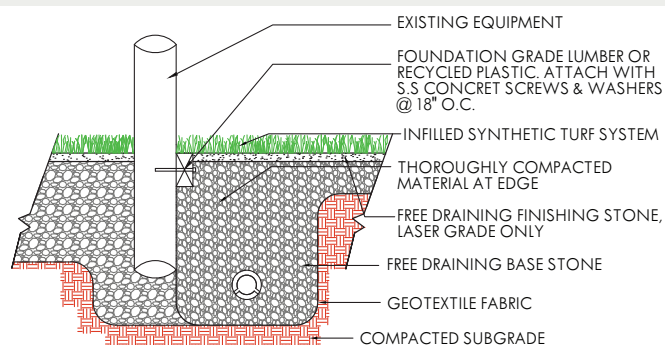

EQUIPMENT