

PL928



APPLICATION

This product was designed specifically for pet areas. The construction of this style blends itself to high wear applications like kennels. Made with a two color face fiber, it's utility is not restricted to just pet areas, also works well as a first cut of fringe.

PROPERTY	DESCRIPTION
Primary/Stalk Yarn Polymer	Polyethylene
Secondary/Thatch Yarn Polymer	Polypropylene
Yarn Cross Section	Polyethylene Slit Film/Texturized Polypropylene
Standard Colors	Field
Coating Type(s)	SilverBack™ Polyurethane
Perforations	Yes
Pile Height	7/8"
Total Fabric Weight	89 oz/yd ²
Fabric Width	12 ft.
Yarn Shape	



Slit-Film



*Custom colors available upon request

200 Howell Dr. Dalton GA 30721

www.cpturf.com

800.564.4492



CONTROLLED
PRODUCTS



PL928

FINISHED FABRIC	ENGLISH SYSTEM		METRIC SYSTEM		ASTM TEST F-1551
Nominal Specification	Value	Units	Value	Units	Method
Pile Height (Nominal)	.875	In.	25.40	mm.	D-5823
Face Weight	60	oz/yd ²	1119	g/m ²	D-5848
Total Fabric Weight	89	oz/yd ²	2034	g/m ²	D-5848
Primary backing Weight	7.4	oz/yd ²	251	g/m ²	D-5848
Secondary Coating Weight	22	oz/yd ²	678	g/m ²	D-5848
Tuft Bind	>8	lbs.	>3.6	Kg.	D-1335
Grab Tear Strength (Average)	>200	lbs.	>91	Kg.	D-5034
Lead Content	<50	ppm	<50	ppm	F-2765
Total Yarn Linear Density	12,600	Denier	6,334	D-Tex	D-1577
Tensile Strength	8.0	lbs.	3.63	Kg.	D-5034
Stitch Rate	13.5	Per 3"	34.29	Per 10 cm	D-5793
Machine Gauge	0.25	In.	.95	Cm.	D-5793
Flammability	TEST	PASSED	TEST	PASSED	D-2859
Water Permeability w/infill	>30	In./Hr.	>76	Cm./Hr.	F-1551
Fiber Thickness	22	mils	235	microns	D-3218
Fabric Width	12	Ft.	3.6	M	None

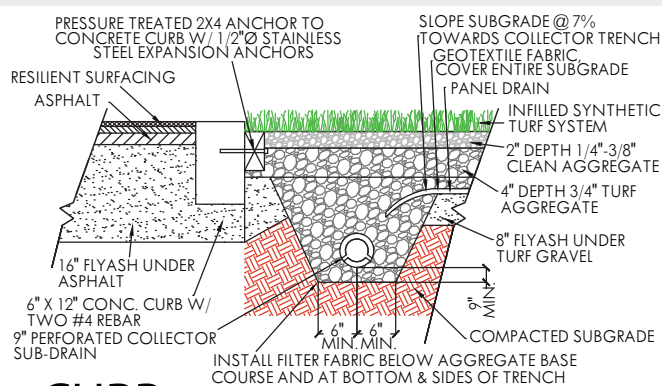

CURB

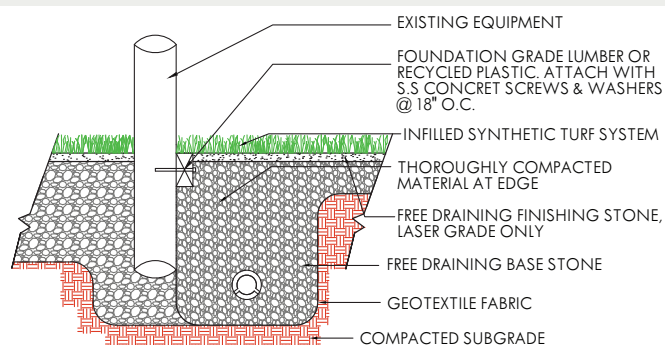

EQUIPMENT