

PL921

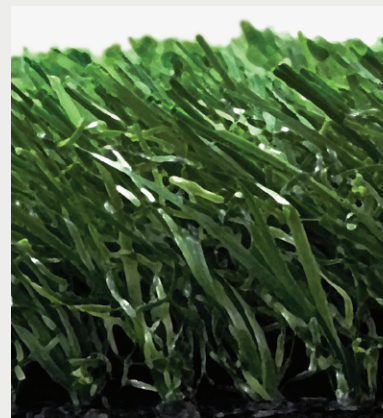

APPLICATION

This is an excellent landscape product that offers thatch, which provides added body, reducing the amount of infill needed. The four color blend of this surface provides a truly authentic look and feel that resembles a natural lawn. This product can be used for landscapes, pet areas, fringes, and much more. This product can be installed indoors or outdoors on concrete or a compacted aggregate base.

PROPERTY

DESCRIPTION

Primary/Stalk Yarn Polymer	Polyethylene
Secondary/Thatch Yarn Polymer	Polypropylene
Yarn Cross Section	Polyethylene Monofilament Classic Spine/ Texturized Polypropylene
Standard Colors	Field/Olive; Field
Coating Type(s)	SilverBack™ Polyurethane
Perforations	Yes
Pile Height	1 3/4"
Total Fabric Weight	84 oz/yd ²
Fabric Width	15 ft.
Yarn Shape	



Quad



*Custom colors available upon request

200 Howell Dr. Dalton GA 30721

www.cpturf.com

800.564.4492



CONTROLLED
PRODUCTS



PL921

FINISHED FABRIC	ENGLISH SYSTEM		METRIC SYSTEM		ASTM TEST F-1551
Nominal Specification	Value	Units	Value	Units	Method
Pile Height (Nominal)	1.75	In.	44.45	mm.	D-5823
Face Weight	55	oz/yd ²	1864.5	g/m ²	D-5848
Total Fabric Weight	84	oz/yd ²	2847.6	g/m ²	D-5848
Primary backing Weight	7.4	oz/yd ²	251	g/m ²	D-5848
Secondary Coating Weight	20	oz/yd ²	678	g/m ²	D-5848
Tuft Bind	>8	lbs.	>3.6	Kg.	D-1335
Grab Tear Strength (Average)	>200	lbs.	>91	Kg.	D-5034
Lead Content	<50	ppm	<50	ppm	F-2765
Total Yarn Linear Density	13,600	Denier	15,110	D-Tex	D-1577
Tensile Strength	8.0	lbs.	3.63	Kg.	D-5034
Stitch Rate	8.5	Per 3"	21.59	Per 10 cm	D-5793
Machine Gauge	0.375	In.	.95	Cm.	D-5793
Flammability	TEST	PASSED	TEST	PASSED	D-2859
Water Permeability w/infill	>30	In./Hr.	>76	Cm./Hr.	F-1551
Fiber Thickness	22	mils	235	microns	D-3218
Fabric Width	15	Ft.	4.6	M	None

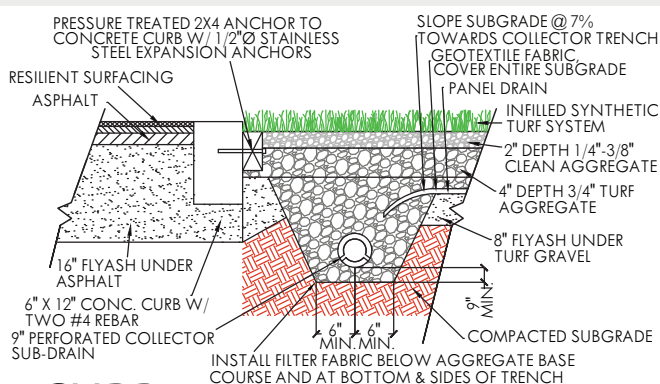

CURB

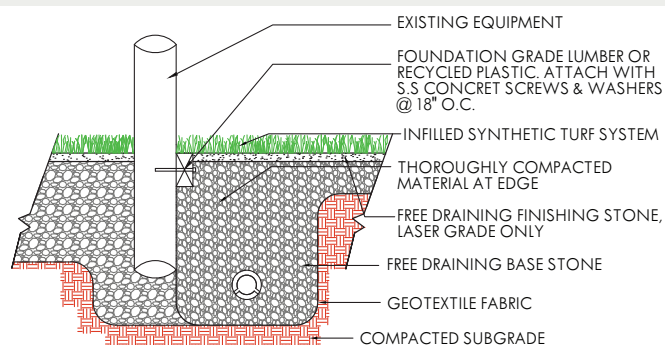

EQUIPMENT