

# PL951-MD



## APPLICATION

This is an excellent landscape product that offers thatch, which provides added body, reducing the amount of infill needed. The four color blend of this surface provides a truly authentic look and feel that resembles a natural lawn. This product can be used for landscapes, pet areas, fringes, and much more. This product can be installed indoors or outdoors on concrete or a compacted aggregate base.

PROPERTY	DESCRIPTION
Primary/Stalk Yarn Polymer	Polyethylene
Secondary/Thatch Yarn Polymer	Polypropylene
Yarn Cross Section	Polyethylene Monofilament/ Texturized Polypropylene Monofilament
Standard Colors	Field/Olive
Coating Type(s)	SilverBack™ Polyurethane
Perforations	Yes
Pile Height	2"
Total Fabric Weight	119 oz.
Fabric Width	15 ft.
Yarn Shape	

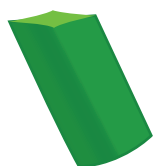

Mini-Diamond



\*Custom colors available upon request

200 Howell Dr. Dalton GA 30721

[www.cpturf.com](http://www.cpturf.com)

800.564.4492



CONTROLLED  
PRODUCTS



# PL951-MD

FINISHED FABRIC	ENGLISH SYSTEM		METRIC SYSTEM		ASTM TEST F-1551
Nominal Specification	Value	Units	Value	Units	Method
Pile Height (Nominal)	2	In.	50.8	mm.	D-5823
Face Weight	92	oz/yd <sup>2</sup>	3,119	g/m <sup>2</sup>	D-5848
Total Fabric Weight	119	oz/yd <sup>2</sup>	4034	g/m <sup>2</sup>	D-5848
Primary Backing Weight	7.4	oz/yd <sup>2</sup>	251	g/m <sup>2</sup>	D-5848
Secondary Coating Weight	20	oz/yd <sup>2</sup>	678	g/m <sup>2</sup>	D-5848
Tuft Bind	>8	lbs.	>3.6	Kg.	D-1335
Grab Tear Strength (Average)	>200	lbs.	>91	Kg.	D-5034
Lead Content	<50	ppm	<50	ppm	F-2765
Total Yarn Linear Density	14,200	Denier	15,778	D-Tex	D-1577
Stitch Rate	12.5	Per 3"	16.25	Per 10 cm	D-5793
Machine Gauge	3/8"	In.	.96	Cm.	D-5793
Flammability	TEST	PASSED	TEST	PASSED	D-2859
Water Permeability w/infill	>30	In./Hr.	>76	Cm./Hr.	F-1551
Fabric Width	15	Ft.	4.6	M	None

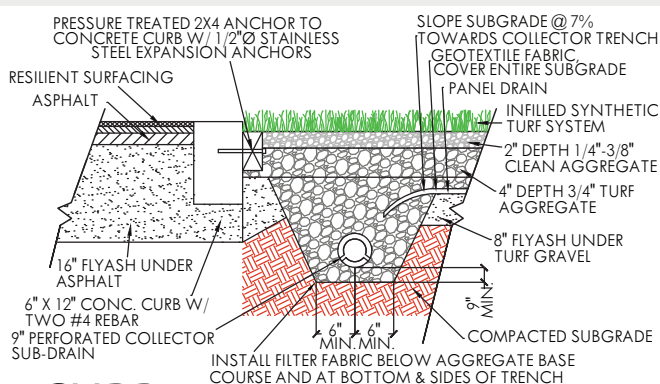

CURB

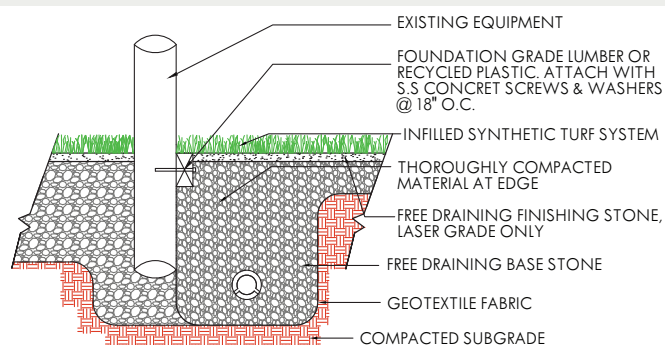

EQUIPMENT